

INSTRUCTIONS

7.5-10HP LAKEWOOD	7.5-10HP NOZZLE
<p>1. INSTALL STUD, SPLIT LOCK WASHER, AND SPACER TO UNIT.</p> <p>2. ALIGN DIFFUSER, FLAT WASHER, SPLIT LOCK WASHER, AND SECURE WITH HEX BOLT.</p>	<p>1. APPLY GREASE TO O-RING GROOVE ON DISCHARGE TUBE. APPLY GREASE TO INSIDE OF NOZZLE IF NECESSARY.</p> <p>2. ALIGN INTERNAL NOTCHES ON NOZZLE WITH GROOVES ON DISCHARGE TUBE AND INSTALL ON DISCHARGE TUBE.</p> <p>3. SECURE BY ROTATING NOZZLE COUNTER CLOCKWISE.</p>

7.5 & 10HP LAKEWOOD

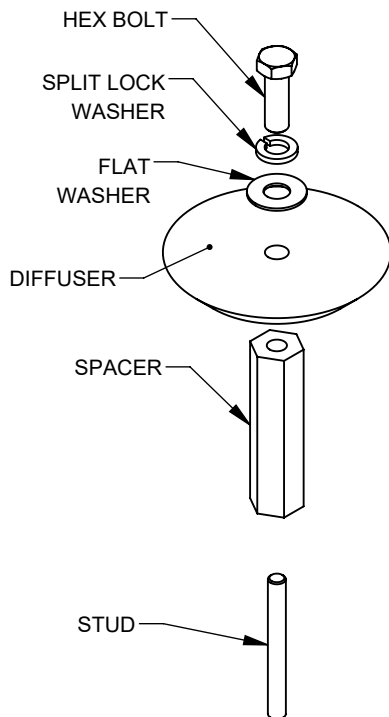

7.5-10HP NOZZLE

CROWN AND GEYSER SHOWN FOR REFERENCE

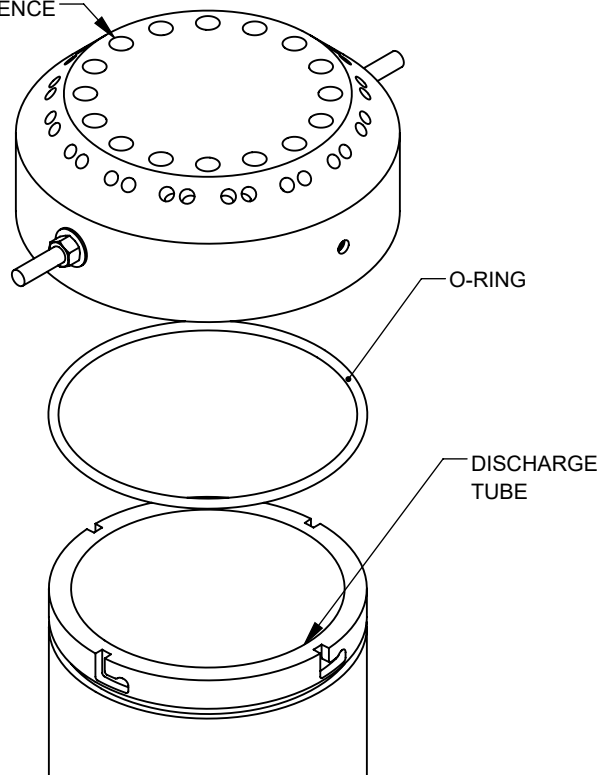

B	7.5HP & 10HP NOW USE THE SAME LAKEWOOD ASSEMBLY	2021-04-07
A	INITIAL CREATION	2021-03-11
REV	DESCRIPTION	DATE
REVISION HISTORY		

